

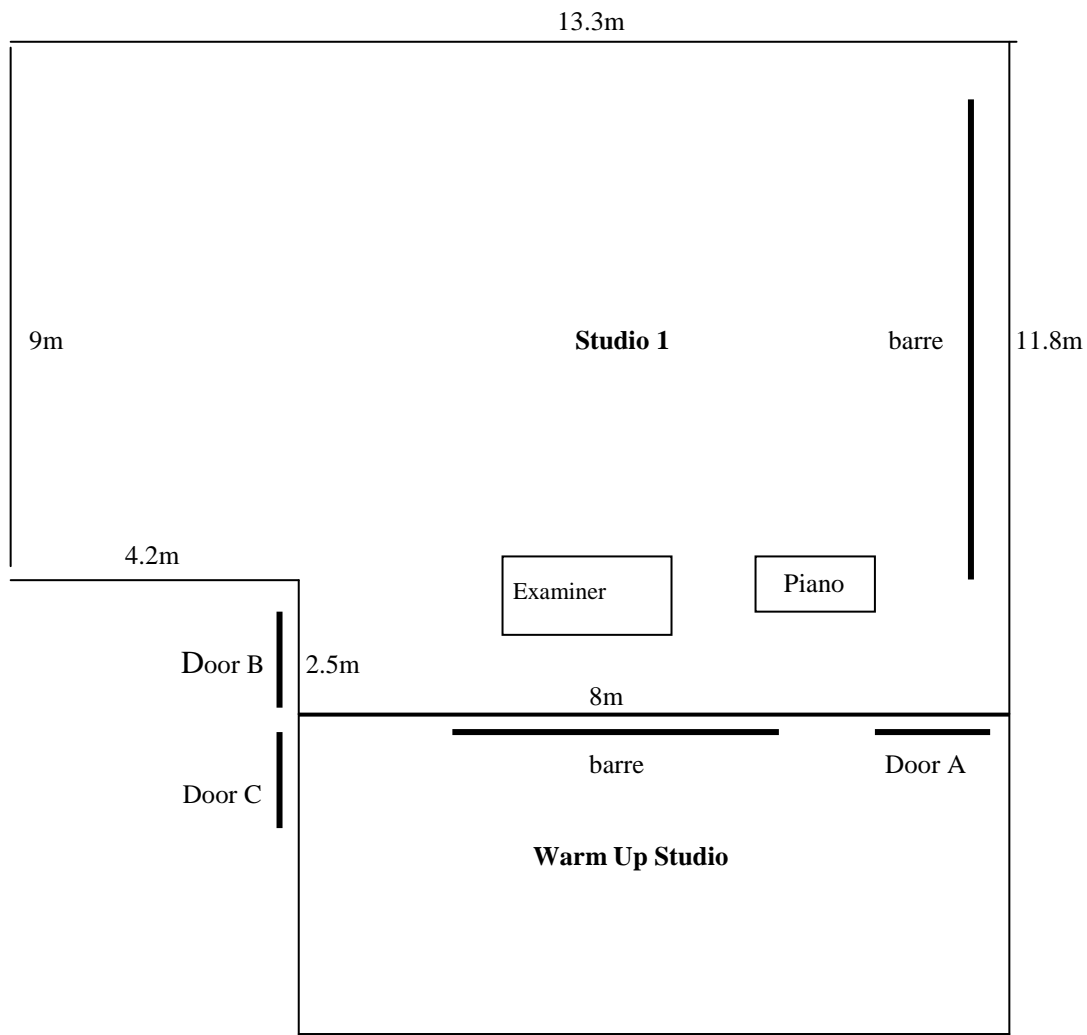

EXAMINATION STUDIO

**20 Farrell Avenue
Darlinghurst NSW 2010
Tel: 02 9331 4111 Fax: 02 9360 6677
Email: exams@rad.org.au**

(not drawn to scale)



Studio 1 is the Official Examination Studio at the Academy’s Sydney office.

Door A is the entrance and exit that candidates take into the examination studio for all Vocational and Graded Examinations, Presentation Classes and Class Awards and is a *fire escape door*

Door B is the entrance and exit for examiner, pianist and staff.

Door C is the entrance to the warm up studio.